



APPLICATIONS AND PRODUCTS GUIDE





Welcome to QualiTru Sampling Systems

Since 1983, QualiTru Sampling Systems® (formerly QMI) has been the leader in the science of aseptic liquid sampling with innovative, easy-to-use, versatile and cost-effective sampling systems that help the dairy, beverage and liquid food industries produce safe, quality products.

Our systems are used by dairy farms, haulers, and liquid food and beverage processing plants across the U.S. and in over 30 countries worldwide to:

- Perform in-process sample testing and quality checks inline, in bulk tanks, and in silos
- Perform microbiological testing and closed system inoculation
- Verify product quality



WHAT IS ASEPTIC SAMPLING?

Aseptic sampling is the collection of samples using a sterile path to mitigate external contamination.

REGULATORY APPROVALS

QualiTru's inline aseptic sampling system is a Pasteurized Milk Ordinance (PMO) approved method for the collection of representative samples from farm bulk milk storage tanks and silos and meets the National Conference on Interstate Milk Shipments (NCIMS) standards. Our products comply with the 3-A Standard 63-04 (Sanitary Fittings) and are authorized to display the industry standard 3-A symbol.

QualiTru Sampling Systems regulatory approvals include:

- FDA M-I-06-12 Needle Only Method
- FDA M-I-08-5 Milk Tank Trucks
- FDA M-I-06-6 Direct Load
- EC1935 compliant
- FDA M-I-12-4 Universal Dairy Farm Samples
- FDA M-I-16-17 Appendix N Samples
- ISO 9001:2015 certification

Accurate Sampling Solutions for the Markets We Serve

Milk Processors: QualiTru systems can be used to collect representative samples of raw milk while the truck is being unloaded at the receiving bay, as well as at critical control points (CCP) throughout the processing plant for performing diagnostics, system quality checks, clean-in-place (CIP) cleanliness checks, and aseptic samples for overall quality testing.

Cheese and Whey Processors: The QualiTru system is ideal for collecting aseptic and representative samples to perform whey analysis for quality testing, monitoring spore counts, and overall inline process monitoring. A port may be installed on the exterior of the vat for inoculation of milk with specific cultures while keeping the system closed to the environment, mitigating the risk of unwanted microorganisms.

Dairy Farms: The QualiTru system provides the best continuous flow sampler for an accurate representative sample of the entire volume of raw milk being collected. As a result, contamination and biofilms can be accurately detected and isolated, and milk quality and overall herd health can be monitored. Proactive sampling and testing saves time, lowers tear-down costs and reduces disrupted production schedules.

Milk Tanker Trucks: The QualiTru system allows for collecting aseptic and representative samples from the side or rear of the truck instead of the top. This improves receiving bay efficiency by allowing samples to be taken before trucks enter the receiving bay, thus reducing congestion and delay in milk unloading. Sampling from the ground also reduces the risk of falls or injuries, providing a safer physical sampling environment for certified samplers.

Wineries: QualiTru systems do not expose oxygen to the process while allowing samples to be drawn for microbiological and chemical testing on silos to help ensure the consistent taste and quality of your wine.

Breweries: QualiTru systems can be customized to help ensure the quality and taste of your beer throughout the manufacturing process. Collect samples throughout the processing plant for water quality, wort sampling, fermentation monitoring, and final product quality.



COLLECTING ACCURATE SAMPLES IS AS EASY AS 1-2-3-4

QualiTru's unique four-part system for aseptic, representative sampling can be customized, allowing the dairy, beverage and liquid food industries to have accurate microbiological and chemical data from beginning to end, building transparency and confidence in product quality.

QualiTru Offers a Complete Line of Aseptic Sampling Products



TRUSTREAM™ Ports

QualiTru's TruStream™ stainless steel sanitary ports are certified to 3-A Standard 63-04 and designed to work in a wide variety of locations, including processing lines, silos, tanks, and liquid tanker trucks. They provide easy, aseptic access to process monitor for microbial contamination, as well as line and tank sampling, helping to ensure confidence in product quality and process with accurate sample data. The QualiTru TruStream 7 ports are ideal for most sampling applications, while the QualiTru TruStream12* ports are specifically designed for inoculation, low-pressure applications, and bioreactors.



*The TruStream12 ports should only be used for processing plant applications.

TRUStream™ Septa

QualiTru's TruStream Septa are sterile and have multi-channel access points made of food-grade materials with either 7- or 12-needle channels. Our septa allow aseptic samples to be drawn through a single-use channel, virtually eliminating the risk of introducing environmental contamination during the sampling process. Each septum has a food safe label to clearly indicate which channels have been pierced with a needle.



Product No.: 110011
TruStream7 Septum



Product No.: 110021
TruStream7 Septum (High Temp)



Product No.: 110064
TruStream12 Septum



Product No.: 110074
TruStream12 Septum (High Temp)



PDF Download:
Best Practices for Using
Your QualiTru Septum



Training Video:
Needle Insertion
Training Guide



QualiTru Sterile Collection Units



Three easy steps for accurate samples with TruDraw.

Insert a 7- or 12-channel septum into the TruStream stainless steel port that has been sanitized with an approved sanitizer spray or alcohol wipes.

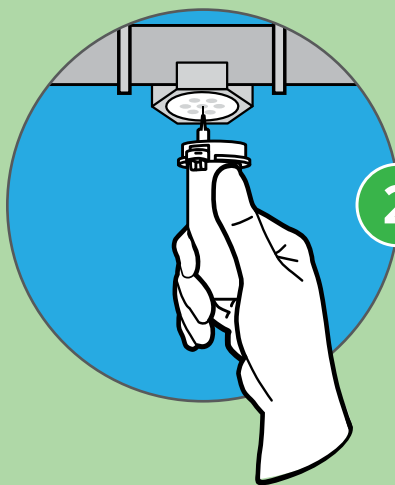
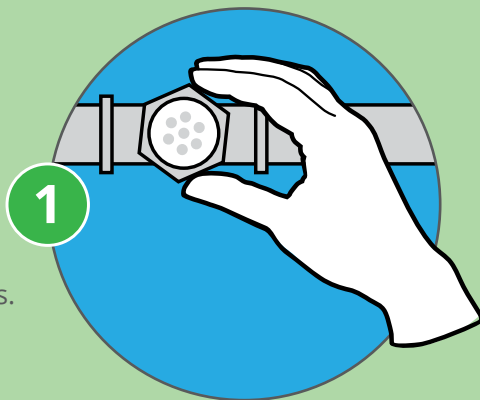

Remove the cover from the needle and insert the needle into a single use channel in the septum. Allow liquid to flow into the collection unit until 3/4 full.

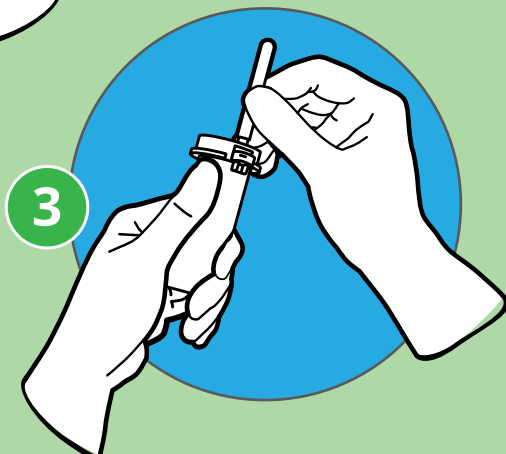

Replace the cover on the needle, remove blue TruDraw cap and discard both in a sharps disposable container.

TRUDRAW® Single Samplers

QualiTru's TruDraw® Single Sampler is designed for two ounce samples and virtually eliminates the risk of exposure to external contamination, ensuring sampling accuracy. Our TruDraws meet the bacterial Appendix J requirements as well as the NCIMS and Appendix N Grade "A" PMO test method requirements for antibiotic residue collection at milk plants, receiving stations, or transfer stations. TruDraw improves operation efficiency by reducing the need to transfer samples and minimizing waste. Our tamper-evident cap also helps ensure a controlled chain of custody at the start of the process. The TruDraw works with all TruStream Septa and is available in the following options:

- **TruDraw Sterile** (Part No. 112021) is designed for use anywhere a small aseptic sample is required and meets regulatory requirements for aseptic sample collection. It is available in individual sterile packages with an attached 18g needle for a leak-proof sample.
- **TruDraw** (Part No. 112022) is designed for use when a small sample of raw milk is required and meets the bacterial requirements of the PMO for farm, milk hauler and pre-pasteurization sample collection. It is sold with a detached 18g needle and easily assembles for a leak-proof sample.

TRUStream™ & TRUMotion™ Sterile Collection Bags

Our TruStream Collection Bags extend aseptic sampling by providing a sterile fluid path and are equipped with a needle and tubing that easily work with all TruStream Septa. Our single-use, disposable collection bags are available in a variety of configurations to accommodate an array of sample size requirements. QualiTru also offers TruMotion™ Collection Bags that are designed to work with peristaltic pumps, creating a continuous flow sampling system that collects a composite sample over an entire process run.

TruStream Collection Bags:

- 250ml/18g (Part No. 111450)
- 2L/18g (Part No. 111730)
- 2L/22g (Part No. 111740)
- 7L/18g (Part No. 111930)

TruMotion Collection Bags for peristaltic pump use:

- 2L/18g w/2.0mm silicone tubing (Part No. 111750)
- 2L/18g w/3.2mm silicone tubing (Part No. 111770)



YOUR TEST RESULT IS ONLY AS ACCURATE AS YOUR SAMPLE.

Finding solutions for contamination can be challenging, frustrating, time-consuming, and sometimes costly! If you have a contamination issue you are having trouble solving or would like to discuss a proactive process monitoring plan, contact us at **(651) 501-2337** or email **sales@qualitru.com** to have one of our experts contact you.



Peristaltic Pumps

QualiTru offers peristaltic pumps in electric and portable models to draw liquid samples into a TruMotion Collection Bag, providing a continuous flow for a representative sample. The electric pump is ideal for sampling the entire process run for inline, pen or payment sampling, while the portable peristaltic pump works best for short duration and troubleshooting sampling applications. Our QualiTru Pump Enclosure is specially designed for the Watson-Marlow Pump to shelter it from water spray.





QualiTru Training Resources

The QualiTru website provides easy-to-follow instructional materials and training videos, many in both English and Spanish. These resources include:

Downloadable PDFs

- Usage Guides and Best Practices
- Illustrated Application Sites for Most Dairy, Beverage and Liquid Food Industries
- Standard Operating Procedures (SOPs)
- Installation Guides
- Technical Specifications
- Validation Studies

Training Videos:

- Diagnostic Sampling and Process Verification Training Guide
- Needle Insertion Training Guide
- Silo Sampling Training Guide
- Inline/Direct Load Sampling System Training Guide
- Appendix N & Antibiotic Truck Sampling Training Guide
- Pen or String Sampling with a Peristaltic Pump Training Guide

ORDERING QUALITRU SAMPLING SYSTEMS IS FAST AND EASY.

Orders and request for quotes (RFQs) can be placed through our website at [qualitru.com/catalog-of-sampling-products](https://www.qualitru.com/catalog-of-sampling-products) or emailed to sales@qualitru.com.

QualiTru Auto-Ship Option: For your convenience, QualiTru can arrange automatic, scheduled shipments for consumables. Just tell us what products, quantity and time you would like your order processed.

Do you have questions about which products would provide the best solutions for your application? Email us at sales@qualitru.com or call **651-501-2337**. Our experienced QualiTru representatives are always happy to help.



©2023 QualiTru Sampling Systems. All rights reserved. MKTG-203 REVA 052023

Sales@QualiTru.com | [651-501-2337](tel:651-501-2337) | [QualiTru.com](https://www.QualiTru.com)