

# IMPROVING DAIRY OPERATIONS THROUGH ACCURATE AND RELIABLE INLINE SAMPLING



Since 1983, QualiTru Sampling Systems has helped dairy processors collect accurate and reliable liquid samples from tanks and pipelines during production. For plants focused on yield, efficiency, consistency, and food safety, QualiTru transforms sampling from a routine task into a practical tool for stronger process control and better operational performance. Today, QualiTru systems are used in over 30 countries to support food safety, process monitoring, and consistent product quality.



## Why Reliable Inline Sampling Matters in Dairy Processing

Every dairy processor relies on laboratory testing to confirm product safety and quality. However, the accuracy of any test depends on one critical factor: *samples that accurately reflect product parameters*. If samples are not collected using hygienic methods that provide controlled and representative samples, the results may give plants misleading information about what is happening inside their process.

Reliable sampling helps dairy plants:

- ✓ Reduce product loss and waste
- ✓ Improve and maintain equipment effectiveness
- ✓ Optimize sanitation cycles
- ✓ Detect process trends and take preventive action
- ✓ Shorten holds and investigations
- ✓ Protect brand reputation and consumer safety

## Return on Investment for Dairy Processors

The economics are simple: the costs of aseptic sampling are minor compared with the cost of lost product, delayed release, troubleshooting labor, and disrupted production. Plants do not need many avoided events for aseptic sampling to deliver a meaningful return.

- One avoided hold, dump, or rework event can outweigh months of sampling cost
- Better samples mean faster investigations and less wasted labor
- More trustworthy data supports better process control and fewer surprises
- The higher the product value, the faster the return on investment (ROI)



## QualiTru. A simple closed-system approach to liquid sampling.

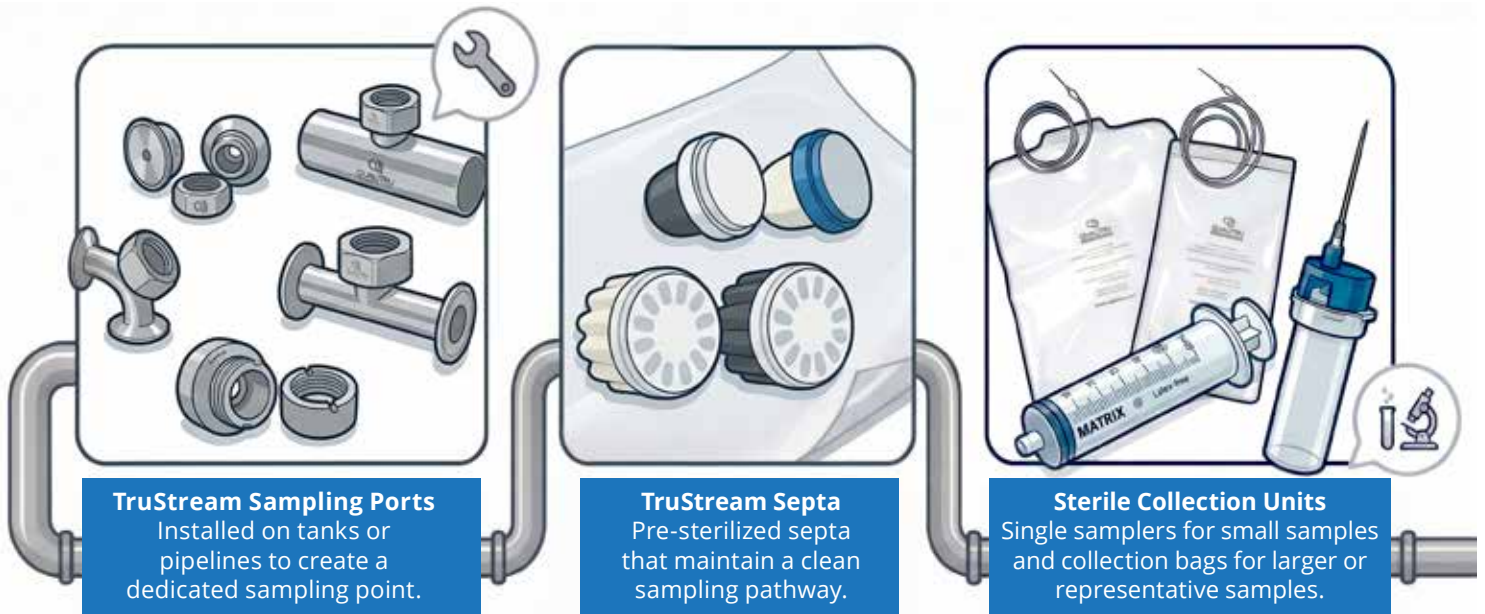

Together these components facilitate equipment effectiveness by reducing contamination risk to the line and to the sample.

### How the System Works

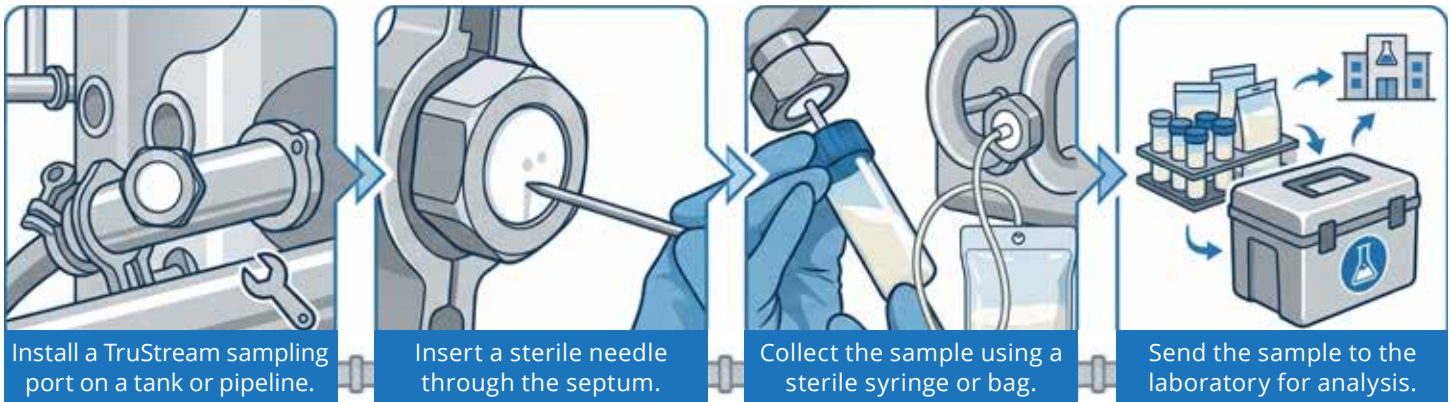

This closed sampling method is less prone to costly contamination than sampling valves, and can be cleaned-in-place effectively.

### Where Sampling Is Used in a Dairy Plant

QualiTru systems allow samples to be collected safely and hygienically from key locations in the production process. Typical sampling points include:

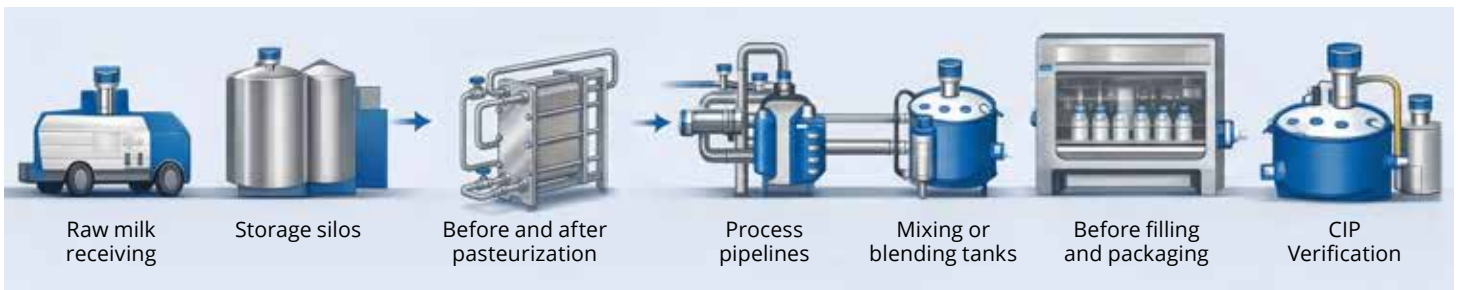

These sampling points help processors understand what is happening throughout the production process and quickly locate potential quality issues.

**QualiTru process experts can tailor sampling guidance specific to plant operations.**